

Data sheet Load cell AS-DBR

Stainless steel double shear beam load cell

- C4 precision class
- 17-4 PH stainless steel
- IP68 protection
- capacities from 10 up to 30 ton
- for approved weighing, tanks, hoppers, silo's.
- shielded connection cable
- **CE** approvable
- **Option:** ATEX II 1G / II 1D ia IIC T6 / TX; ATEX II 1D ta IIIC TX °C certified



Type AS-DBR

Minimum load cell verification interval:	$V_{min} = E_{Max} / 10.000$
Full Scale Output:	2mV/V +/- 0.1%
Combined error:	0,03% of Full Scale Output (F.S.)
Temperature effect on zero:	+/- 0,00116/°C
Temperature effect on full scale output:	0,00097%/°C
Compensated Temperature Range:	-10°C/+40°C
Operating Temperature Range:	-30°C/+85°C
Creep error after 30 minutes:	+/- 0.02% F.S.
Maximum tolerated excitation voltage:	15 VDC
Input Resistance:	700 ± 7 Ohm
Output Resistance:	700 ± 7 Ohm
Insulation Resistance:	> 5000 MOhm
Safe Overload:	150% F.S.
Ultimate Overload:	>300% F.S.
6-wire shielded cable:	15m long
Capacities:	10,000 / 20,000 / 30,000 kg

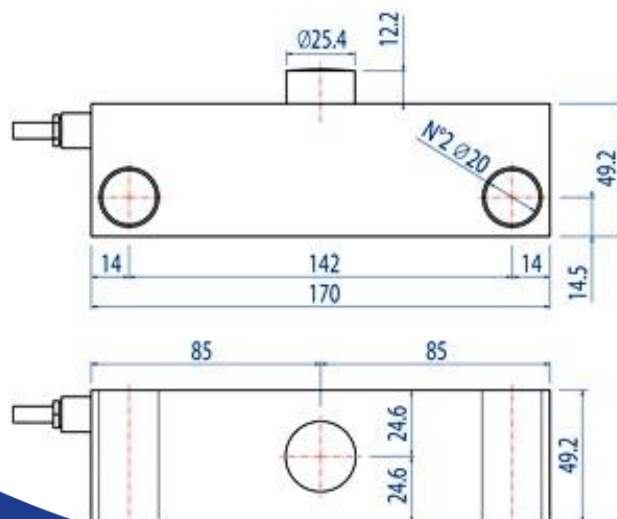

Wiring Code	
Colour	Function
--	Shield
Green	Output +
Purple	Sense +
Red	Input +
White	Output -
Black	Output -
Grey	Sense -